

Basket Strainer

Specifications

- NPT or BSPT blowoff outlet on body. Blowoff outlets are finished with plugs.
- Screens are perforated 304 stainless steel with spot welded seam.
- Recessed seat in body assures accurate screen alignment.
- Flanged and Drilling complies with EN1092-2 PN16/25, ANSI B 16.1 Class125 or ANSI B16.2 Class250.
- Rated Working Pressure
Fig.7105: 16 bar for DN50 to DN600.
Fig.7108: 25 bar for DN50 to Dn300.
- FIG:7105 Certificated to ANSI / NSF 61 & 372.

Corrosion Protection

- Fusion Bonded Coating or Liquid Epoxy Painted Interior and Exterior.

Option

- 150 psi available.

Material Specification

Part	Material	EN Specification	ASTM Specification
Body	Gray Cast Iron	EN 1561 EN-GJL-250	A126 Class B
	Ductile Iron	EN 1563 EN-GJS-450-10	A536 Grade 65-45-12
Cover	Gray Cast Iron	EN 1561 EN-GJL-250	A126 Class B
	Ductile Iron	EN 1563 EN-GJS-450-10	A536 Grade 65-45-12
Gasket	Graphite		
Screen	Stainless Steel	EN 10088 X5CrNi18-10	A276 Type 304
Plug	Gray Cast Iron	EN 1561 EN-GJL-250	A126 Class B

- Other material types are available upon request.

Standard Screens

Size	Hole Dia.	Opening Ratio
DN50 to DN80	1.5mm	26%
DN100 to DN600	3.0mm	40%

Main Dimensions (mm)

Size	DN50	DN65	DN80	DN100	DN125	DN150	DN200	DN250	DN300	DN350	DN400	DN450	DN500	DN600
L	207	210	251	292	334	378	475	511	680	769	842	842	842	1054
A	225	250	297	330	370	410	530	615	770	750	920	970	1110	1285
B	128	155	190	202	218	243	305	335	425	408	533	535	591	760
Plug	1/2"	3/4"	3/4"	1"	1"	1"	1-1/2"	1-1/2"	2"	2"	2"	2"	2"	2"

Notes

- Designs, materials and specifications shown are subject to change without notice due to the continuous development of our products.

Schematic

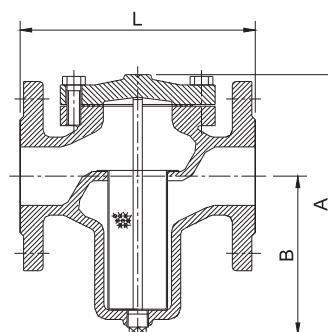
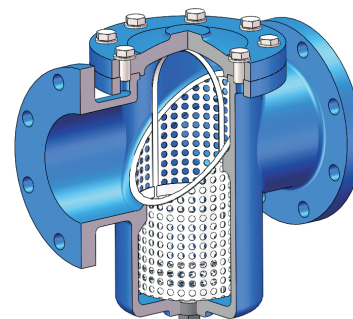

Size DN50

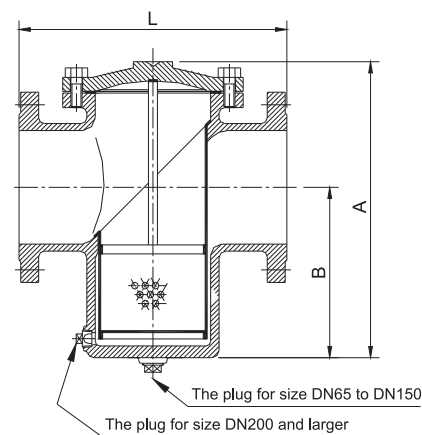

Size DN65 and Larger