

## Balancing Valve Flanged Ends & Grooved Ends

**FIG. 1209**  
**FIG. 1210**

### Specifications

- Inside Screw, Non-rising Stem.
- EPDM Coated Disc.
- Back Seating Feature.
- Can be set in conjunction with flow charts.
- Two test points located on each valve.
- Flanged and Drilling complies with EN1092-2 PN10/16, ANSI B 16.1 Class125.
- Face to Face Dimension in accordance with EN558-1 basic series 1.
- Rated Working Pressure 16 bar / 250 psi.

### Corrosion Protection

- Fusion Bonded Coating Interior and Exterior.

### Option

- 20 bar /25 bar /300 psi available.

### Material Specification

Part	Material	EN Specification	ASTM Specification
<b>Body</b>	Ductile Iron	EN 1563 EN-GJS-450-10	A536 Grade 65-45-12
<b>Disc</b>	EPDM Encapsulated Ductile Iron		
<b>Disc Nut</b>	Brass	EN 12165 CuZn39Pb1	B124 C37700
<b>Stem</b>	Stainless Steel	EN 10088-3 X20Cr13	A276 Type 420
<b>O-Ring</b>	Rubber	EN 681 EPDM	D2000 EPDM
<b>Bonnet</b>	Ductile Iron	EN 1563 EN-GJS-450-10	A536 Grade 65-45-12
<b>Gasket</b>	Rubber	EN 681 EPDM	D2000 EPDM
<b>Handwheel</b>	Ductile Iron	EN 1563 EN-GJS-450-10	A536 Grade 65-45-12

### Schematic

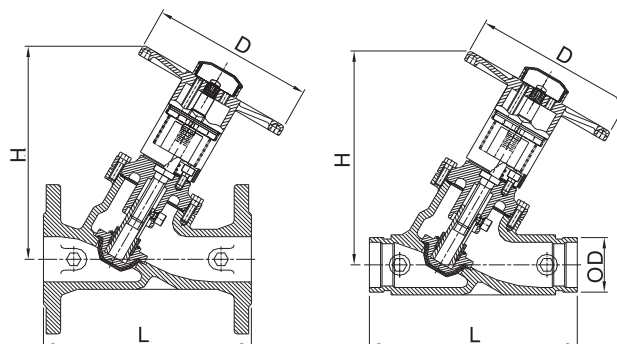
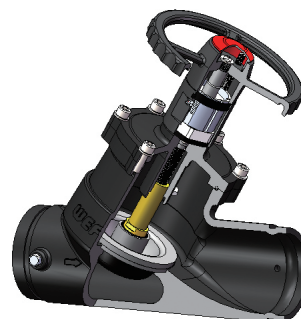
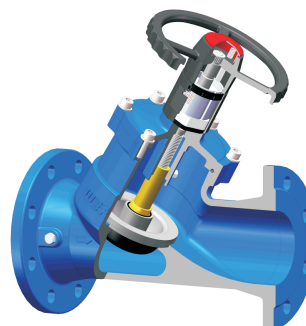

### Main Dimensions (mm)

Size	DN50	DN65	DN80	DN100	DN125	DN150	DN200	DN250	DN300
<b>L</b>	230	290	310	350	400	480	600	730	850
<b>H</b>	248	279	294	313	357	399	463	554	566
<b>D</b>	205	205	205	205	300	300	300	450	450
<b>OD</b>	60.3	73/76.1	88.9	114.3	139.7/141.3	165.1/168.3	219.1	273	323.9

### Notes

- Designs, materials and specifications shown are subject to change without notice due to the continuous development of our products.