

## EN 593 Double Eccentric Butterfly Valve

FIG. 2106

### Specification

- Meet or exceed the requirements of EN593.
- Double Eccentric Type.
- Rubber Seat clamped on the Disc.
- Stainless Steel Seat welded on the Body.
- Mounting Flange in accordance with ISO 5211.
- Flange and Drilling comply with EN1092 PN10/16.
- Face to Face Dimension complies with EN558 Series 13 or Series 14.
- Rated Working Pressure:  
16 bar for size 80 to 1200  
10 bar for size 1400 to 2400
- Certificated to ANSI / NSF 61 & 372.

### Corrosion Protection

- Fusion Bonded Coating or Liquid Painting Interior and Exterior.

### Material Specifications

Part	Material	EN Specification
Body	Ductile Iron	EN 1563 EN-GJS-450-10
Body Seat	Stainless Steel	EN 10088 X5CrNi18-10
Shaft	Stainless Steel	EN 10088 X20Cr13
Disc	Ductile Iron	EN 1563 EN-GJS-450-10
Disc Seat Ring	Rubber EPDM	EN 681
Disc Holding Plate	Stainless Steel	EN 10088 X5CrNi18-10
Shaft Bushing	Bronze	EN 12167 CuAl10Fe3
Shaft Sealing	O-Ring	EN 681 BUNA-N
Bottom Plate	Carbon Steel	EN 10025 S235JR

### Options

- WRAS Approved Fusion Bonded Coating or Liquid Painting and Rubber seated.
- BUNA-N Bonded Disc Seat.

### Schematic

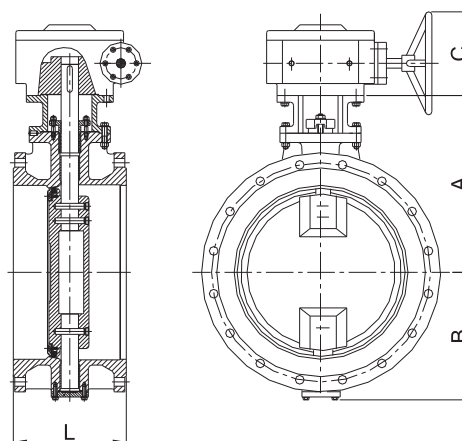

### Main Dimensions (mm)

Size	80	100	125	150	200	250	300	350	400	450	500	600
L	Series 13	114	127	140	140	152	165	178	190	216	222	267
	Series 14	180	190	200	210	230	250	270	290	310	330	390
A		193	205	225	235	285	315	360	405	450	510	610
B		123	135	145	155	195	205	250	270	315	365	440
C		120	120	160	160	160	160	200	200	230	230	260

Size	700	800	900	1000	1200	1400	1600	1800	2000	2200	2400	-
L	Series 13	292	318	330	410	470	530	600	670	760	800	-
	Series 14	430	470	510	550	630	710	790	870	950	1030	-
A		655	720	770	880	1000	1110	1275	1360	1653	1725	-
B		475	540	600	665	800	895	1055	1120	1335	1415	-
C		260	260	335	335	335	350	400	400	520	520	-

#### Notes

- Designs, materials and specifications shown are subject to change without notice due to the continuous development of our products.